

2011

**Minority Fellowship Program
Intensive Winter Institute**

The Human Genome and Personalized Medicine:
Mental Health and Substance Abuse Disorders
Prevention and Treatment in a Diverse Society

February 10-13, 2011

Durham, North Carolina



February 10, 2011

To the Fellows of the SAMHSA Minority Fellowship Program,

Duke University School of Nursing is honored to host the 2011 Intensive Winter Institute, and we extend to you a warm welcome. In the spirit of the Duke nursing tradition, we trust that this year's institute will foster a vibrant exchange of ideas regarding genomic science and its implications for psychiatric and substance abuse issues in diverse populations.

Established in 1931, Duke University School of Nursing ranks among the top nursing schools in the nation. We are known for our distinguished faculty, excellent academic programs at the bachelors, masters, and doctoral levels, and cutting-edge research. We are proud of our long-standing tradition of innovation and leadership.

With an ever-increasing worldwide need for well qualified nursing professionals, we hold strong our commitment to fostering the development of scientists and clinicians who can address critical societal and scientific issues. We embrace opportunities to conduct and translate research that will solve the most pressing health care challenges facing our world.

As we expand existing programs and create new initiatives, we are directly responding to the growing global needs for culturally competent nursing care, effective health care systems, and leadership in the field of nursing. By developing new partnerships at Duke and beyond, we are meeting emerging needs in the field of health care education and helping to eliminate health disparities.

On behalf of the Duke University School of Nursing, I thank you for joining us and for your contributions to nursing and to society. May your time here in Durham be fruitful as you explore culturally sensitive prevention, early detection, and treatment interventions for vulnerable groups.

Catherine L. Gilliss, DNSc, RN, FAAN
Helene Fuld Health Trust Professor of Nursing
Dean, Duke University School of Nursing
Vice Chancellor for Nursing Affairs, Duke University

The Human Genome and Personalized Medicine: Mental Health and Substance Abuse Disorders Prevention and Treatment in a Diverse Society

The goal of the 2011 Intensive Winter Institute is to facilitate trans-disciplinary practice and collaborative research related to substance abuse and psychiatric genetics to improve the health promotion, early detection, prompt treatment, and the prevention of disorders across the life span. Personalized medicine will be discussed from the perspective of science and culture in a diverse society.

OBJECTIVES

Explore the basic scientific principles of the human genome and personalized medicine.

Discuss the clinical applications of the developing genomic science and personalized medicine.

Discuss how genetic knowledge interacts with philosophical, cultural and racial (a social construct) perception.

Discuss the inherent destiny of genes and its overlap with environmental influence, family, and stress as related to substance abuse and psychiatric conditions.

Examine issues related to the integration of genetic technologies, research methods, principles of measurement, approaches to population health research, and health outcomes.

PROGRAM

THURSDAY, FEBRUARY 10, 2011

Meetings are in the Forest Room unless otherwise noted.

- 2:00 p.m. **Orientation of New Fellows**
Faye Gary
Convener: Eugenia Millender
New Fellows: Billie Jean (B.J.) Kosak, Sophia Mason, Marie McDade
- 3:00 p.m. **Registration**
Fellows' Focus Group
Faye Gary
- 4:00-7:00 p.m. **Reception**
Buffet - Academy Room
- 4:30 p.m. **Welcome**
Conveners: Tanya Sorrell, Gary Lawrence
- 4:40 p.m. **Welcome and Opening Remarks**
Catherine Gilliss
- 5:00 p.m. **Introduction of Guests**
Catherine Gilliss
- 5:30 p.m. **Graduation Ceremony and the Awarding of MFP Diplomas**
- Marife Aczon-Armstrong, PhD, RN
Dissertation: Relationships of Depression to Substance Use, Chronic Illnesses and Asian American Pacific Islander Adults in Hawaii
Advisor: Jillian Inouye, PhD, RN, FAAN
University of Hawaii at Manoa, Honolulu, HI
- Bridgette Brawner, PhD, RN
Dissertation: Depression and HIV Risk Related Sexual Behaviors among African American Females
Advisor: Christopher Coleman, PhD, RN
University of Pennsylvania, Philadelphia, PA
- Barbara Dahlen, PhD, RN
Dissertation: Giving Voice to Historical Trauma through Storytelling: The Impact of the Boarding School Experience on American Indians
Advisor: John Lowe, PhD, RN, FAAN
Florida Atlanta University, Boca Raton, FL

PROGRAM

THURSDAY, FEB 10, 2011 (CONT)

Meetings are in the Forest Room unless otherwise noted.

Kathryn Aimee Fuller, PhD, RN

Dissertation: A Retrospective Study of Substance Use and Mental Health Disorders in a Sample of Urban American Indians and Alaska Natives

Advisor: Cynthia D. Connelly, PhD, RN, FAAN

University of San Diego, San Diego, CA

Kim Jolly, PhD, RN

Dissertation: Immigrant Status, Substance Use, and Sexual Risk among Afro-Caribbean Adolescents Living in South East Florida

Advisor: Patricia Liehr, PhD, RN, FAAN

Florida Atlantic University, Boca Raton, FL

Robert Pope, PhD, RN

Dissertation: Older African Americans and Illicit Drug Use: A Qualitative Study

Advisor: Margaret Wallhagen, PhD, RN, FAAN

University of California San Francisco, San Francisco, CA

Brandon Respress, PhD, MPH, RN

Dissertation: Social Determinants of Adolescent Risk Behaviors: An Examination of Depressive Symptoms, Sexual Risk, Substance Use, and Suicide Risk

Advisor: Diana Morris, PhD, RN, FAAN

Case Western Reserve University, Cleveland, OH

Christina Leal Wei, PhD, RN

Dissertation: The Lived Experience of Men Who Are Court-Ordered to Attend a Batterers' Intervention Program and Who Use or Are Abstaining from Alcohol and other Drugs

Advisor: Margaret H. Brackley, PhD, APRN, BC

The University of Texas Health Science Center at San Antonio, San Antonio, TX

Cheryl Woods-Giscombe, PhD, RN

Postdoctoral Research: The Association of Race-Related, and Generic Stress with Global Distress and Coping among African American Women

Mentor: Linda S. Beeber, PhD

The University of North Carolina at Chapel Hill, Chapel Hill, NC

Address: A Legacy for Yesterday, Today, and Tomorrow

Dorothy Powell

Awarding of Diplomas

Faye Gary, Catherine Gilliss, Dorothy Powell

5:45 p.m.

Introduction of Fellows

Faye Gary, Tanya Sorrell, Gary Lawrence

PROGRAM

THURSDAY, FEB 10, 2011 (CONT)

Meetings are in the Forest Room unless otherwise noted.

6:45 p.m. **Concluding Remarks**
Catherine Gilliss
Conveners: Mary Black, Robert Pope

7:00-9:00 p.m. **Individual and Small Group Consultation**
Faye Gary, Hossein Yarandi

9:00—10:00 p.m. **Appointment:** Sheila Harvin, Mary Black, Beverly Patchell, Brandon Respress

FRIDAY, FEB 11, 2011

Meetings are in the Forest Room unless otherwise noted.

7:15-8:30 a.m. **Breakfast—Academy Room**
Convener: Bruce Kafer

Giving Voice to Historical Trauma through Storytelling: The Impact Of the Boarding School Experience on American Indians Caregivers of Adults with Dementia
Barbara Dahlen

American Indian Caregivers of Adults with Dementia
Mary Black

8:30 a.m. **Break**

8:45 a.m.-Noon **Symposia**
Conveners: Marie McDade, Kathryn Aimee Fuller

Introduction to the Human Genome and Personalized Medicine: Improving Health Outcomes across the Life Span among Culturally Diverse Populations

8:45 a.m. **Greetings and Overview of Program**
Catherine Gilliss, Geoffrey Ginsburg

9:00 a.m. **Overview of the Basics: Introduction to the Human Genome and Personalized Medicine**
Geoffrey Ginsburg

9:45 a.m. **How does Personalized Medicine Advance Human Health?**
Alex Cho

PROGRAM

FRIDAY, FEB 11, 2011 (CONT)

Meetings are in the Forest Room unless otherwise noted.

10:30 a.m. **Break**

11:00 a.m. **Applying the Principles: Personalized Medicine, Diabetes and Cardiovascular Disease**
Alex Cho, Allison Vorderstrasse

11:30 a.m. **Overview of the Research Approaches to Addressing Genomic Questions in Nursing**
Jennifer Dungan

Noon-1:30 p.m. **Lunch - Academy Room**

Evolutionary Versus Racial Medicine: Why It Matters
Joseph Graves, Jr.

1:45 p.m. **Symposia**
Conveners: Marie McDade, Kathryn Aimee Fuller

Integrating Genomic Science and Personalized Medicine Approaches into Your Nursing Research: An Interactive Workshop
Jennifer Dungan, Allison Vorderstrasse

2:45 p.m. **Break**

3:00 p.m. Board the bus at the front entrance of Washington Duke Inn for trip to Hayti Heritage Center. (Please visit <http://www.hayti.org/> for more information about this historic center.)
Conveners: Barbara Dahlen, BJ Kosak, Suzette Lettsome

3:30-4:30 p.m. **Hayti Heritage Center Tour**
809 Old Fayetteville Street
Durham, NC 27701
(Wear comfortable shoes)

6:00-8:00 p.m. **Dinner - Academy Room**

PROGRAM

SATURDAY, FEB 12, 2011

Meetings are in the Forest Room unless otherwise noted.

Composing a Career: A Conversation with Catherine L. Gilliss

Conveners: Robert Pope, Teresa Richardson

8:30 a.m.

Breakfast—Academy Room

Research Presentations

Conveners: Sophia Mason, Beverly Patchell

Kathryn Aimee Fuller

A Retrospective Study of Substance Use and Mental Health Disorders in a Sample of Urban American Indians and Alaska Natives

Sheila Harvin

Impact of Substance Use and Intimate Partner Abuse on Children

10:00 a.m.

Break

10:15 a.m.-Noon

Research Presentations

Conveners: Stephanie Rodriguez, Eugenia Millender

Bruce Kafer

Historical Trauma among the Oglala Sioux US Military Veterans Living on the Pine Ridge Reservation

Tanya Sorrell

Mexican Traditional Medicine Practitioners: Approaches to Mental Health Treatment and Disease Prevention

12:00-1:30 p.m.

Lunch - Academy Room

1:45 p.m.

Statistics (computers required)

The Concept of Measurement

Research Design and Methods in Human Genetics

Hossein Yarandi

Conveners: Mary Black, Suzette Lettsome

3:30 p.m.

Break

PROGRAM

SATURDAY, FEB 12, 2011 (CONT)

Meetings are in the Forest Room unless otherwise noted.

3:45-5:00 p.m. **Grant Writing Guidelines in Genetics Research: Purpose Statement, Specific Aims, Hypotheses, Methods, Data Analyses, and Human Subjects**

5:45 p.m. Board the bus at the front entrance of Washington Duke Inn
Bus to home of Catherine and Tom Gilliss

6:00-8:00 p.m. **Dinner at the home of Catherine and Tom Gilliss**
Conveners: Robert Pope, Beverly Patchell
10 Old Hope Creek Path
Durham, NC

SUNDAY, FEB 13, 2011

Meetings are in the Forest Room unless otherwise noted.

7:15-8:30 a.m. **Breakfast—Academy Room**

Research Presentations

Conveners: Gary Lawrence, Kathryn Aimee Fuller

Eugenia Millender

The Relationship between Acculturation Stress and Substance Abuse among Guatemalan-Mayan Adolescents Living in South Florida

Suzette Lettsome

Intersections among Depression, Substance Abuse, Obesity, Violence, and Hypertension among African American and Afro Caribbean Women

Stephanie Rodriguez

Substance Abuse and Mental Health Disorders among Hispanic Families

8:30 a.m. **Break**

8:45-10:45 a.m. **Research Presentations**

Conveners: Robert Pope, Sheila Harvin

Beverly Patchell

Historical Trauma: How Identity and Self-Esteem Develops and is Influenced by Past and Current Communication Media in Children and Youth

Gary Lawrence

Depression among American Indian Adults with Diabetes

PROGRAM

SUNDAY, FEB 13, 2011 (CONT)

Meetings are in the Forest Room unless otherwise noted.

B.J. Kosak
Depression in Substance Abusing Females

10:45-11:00 a.m. **Break**

11:00 a.m.-Noon **Research Presentations**
Conveners: Suzette Lettsome, Mary Black

Teresa Richardson
The Association between Perceived Stress, Anxiety and Depressive Symptoms in African American School Aged Youths Who Bully

Sophia Mason
Substance Use and Smoking Behaviors among Individuals with Chronic Mental Illness

Marie McDade
Attachment Relationships, Anger, Violence and other Risk-Behaviors among African American and Hispanic Youths

Noon **Institute Adjourns**
Remarks: Faye Gary

Box lunches available outside of the Forest Room.

Transportation to the airport has been pre-arranged. Please review the schedule that is available in your Institute registration materials.

PRESENTERS



Representing Duke

Catherine L. Gilliss, DNSc, RN, FAAN, dean, Duke University School of Nursing, Helene Fuld Health Trust Professor of Nursing, and vice chancellor for nursing affairs, Duke University, is a graduate of Duke's undergraduate nursing program. She is the first alumna in the School's history to hold the position of dean. She is also the first-ever vice chancellor for nursing affairs at Duke. Additionally, Gilliss is director of the Duke Translational Nursing Institute, one of five core components of the Duke Translational Medicine Institute established in 2006 with a \$52.7 million clinical and translational science award from the National Institutes of Health. She is president of the American Academy of Nursing and has served as president for the National Organization of Nurse Practitioner Faculties, the Kappa Chapter of Sigma Theta Tau International, and the interdisciplinary Primary Care Fellowship Society. Her career has been devoted to graduate nursing education, specifically the preparation of nurse scientists and advanced practice nurses for roles in primary care. Her scientific focus is the family and chronic illness.

Dorothy L. Powell, EdD, RN, FAAN, professor, associate dean for global and community health initiatives, Duke University School of Nursing (DUSON), is responsible for leading DUSON in addressing address health disparities locally and abroad through academic enrichment, service-learning, and research. The Office of Global and Community Health Initiatives is responsible for developing opportunities for undergraduate and graduate students to have cultural immersion and residency experiences in developing countries and/or with vulnerable populations locally. While at Howard University, Powell developed a unique career training program, Nursing Careers for Homeless People, that has won national recognition. Through this program, nearly 90 previously homeless men and women were trained for careers in nursing ranging from nursing assistants to baccalaureate-prepared registered nurses. Powell has been engaged in international development work, primarily focused in southern Africa, and has provided technical assistance and consultation on primary

health care development to ministries of health, schools of nursing, hospitals and health care systems in Swaziland, Malawi, Zimbabwe, Lesotho, and South Africa.

Geoffrey S Ginsburg, MD, PhD, director, Center for Genomic Medicine, Duke Institute for Genome Sciences and Policy, founding director of the Center for Genomic Medicine in the Duke Institute for Genome Sciences and Policy, and he is also professor of medicine and of pathology. His research focuses on the development of translational pathways for genomics to human health. Prior to coming to Duke in September 2004, Ginsburg was on the faculty of Harvard Medical School, and he was vice president of Molecular and Personalized Medicine at Millennium Pharmaceuticals, Inc. He is a founding member of the Personalized Medicine Coalition, editorial advisory board member for Science Translational Medicine and MedScape Genomic Medicine, senior consulting editor for The Journal of the American College of Cardiology, editor-in-chief of The HUGO Journal, and co-editor of Genomic and Personalized Medicine, published in 2009. He is a member of the National Advisory Council for Human Genome Research, the Board of External Experts for the National Heart Lung and Blood Institute, and the Institute of Medicine's Roundtable on Translating Genomics to Health.

Alex Han Cho, MD, MBA, assistant professor of medicine, Department of Medicine, Duke University School of Medicine, works with Chancellor for Health Affairs Dr. Victor Dzau on special projects related to health policy and new models of care. Cho became involved with DukeEngage, a civic engagement program for undergraduates, through collaborations with entrepreneurial Duke students and in partnership with a Ugandan medical colleague in search of resources and support for a new hospital in Uganda. In the three years since its establishment, DukeEngage has attracted more than 1,500 student applications. More than 800 students have participated in service around the world since DukeEngage began. DukeEngage has also attracted

PRESENTERS



Representing Duke

faculty into its leader ranks. Their reasons include being inspired by a connection to their research, an opportunity to work with students, or a chance to enhance their teaching back at Duke.

Allison A. Vorderstrasse, DNSc, MSN, APRN, assistant professor, Duke University School of Nursing, is an adult nurse practitioner whose clinical practice and scholarship focuses on chronic illness, particularly in ethnic minority populations. Vorderstrasse's doctoral dissertation research, recent publications, and national presentations illuminate the relationships of psychosocial factors with dietary intake in Black American women with Type 2 diabetes. She has also examined the validity of common dietary assessments for use in clinical practice and research. Her findings have contributed to the literature and to the debate on how best to assess dietary intake in persons with chronic illness, particularly given the extent of obesity in the U.S. and the need for dietary modification interventions at the clinical level. Vorderstrasse's current work explores social support in Black women with Type 2 diabetes and the feasibility of providing diabetes education and support using virtual environments. She is also collaborating with colleagues in genetics, behavioral medicine and primary care to examine the clinical utility of genetic testing in combination with traditional risk assessment for cardiovascular disease in primary care in the context of behavioral intervention.

Jennifer Dungan, PhD, RN, research associate, Duke University School of Nursing, is a nursing scientist in the area of cardiovascular genetics. Her research is focused on identifying genetic/genomic variants in cardiovascular disease and aging phenotypes. Dungan has used genetic and genomic approaches in her research toward improving cardiovascular health in aging populations, synthesizing her backgrounds in nursing, cardiovascular disease, genetics, and aging. She has conducted genomic research to identify gene expression signatures in hypertension, exercise training, and

cardiovascular medication use, as well as gene association investigations for hypertension and coronary artery disease. She is currently funded by the NIH/NINR, through a K99 Pathway to Independence Award. Through this project, she established a phenotype for "survivorship" in coronary artery disease (CAD) by identifying genes that vary by survival and age in people with CAD, in addition to characterizing age- and survival-biases in the context of gene association studies. She is also testing statistical methods to control for these biases in order to refine gene associations with cardiovascular disease.

Joseph L. Graves, Jr., PhD, professor and associate dean for research, Joint School of Nanoscience and Nanoengineering, North Carolina A&T and the University of North Carolina-Greensboro, focuses his research on the evolutionary genetics of postponed aging, biological concepts of race in humans, and detecting molecular signatures of natural selection. He has published more than sixty papers and book chapters and appeared in six documentary films and numerous television interviews on these general topics. His books on the biology of race are entitled "The Emperor's New Clothes: Biological Theories of Race at the Millennium," Rutgers University Press, 2001, 2005, and "The Race Myth: Why We Pretend Race Exists in America," Dutton Press, 2004, 2005. A summary of Graves's research career can be found on Wikipedia. He is also featured in the ABC-CLIO volume on Outstanding African American scientists. He is currently serving as chair of the senior advisory board for the National Evolutionary Synthesis Center at Duke University.

FELLOWS

Mary Black	University of Minnesota, Twin Cities	maryblack@gmail.com
Barbara Dahlen	MFP Alumna, Class of 2010 Sisseton Wahpeton Sioux Tribal College	drdahlen@hotmail.com
Aimee Fuller	MFP Alumna, Class of 2011 University of San Diego	Aimeeerb2@yahoo.com
Sheila Harvin	Prairie View A&M University	shharvin@pvamu.edu
Coretta Jenerette	MFP Alumna, Class of 2004 University of North Carolina, Chapel Hill	jenerette@email.unc.edu
Kim Jolly	MFP Alumna, Class of 2009 Broward Health Department	K1jolly@browardhealth.org
Bruce Kafer	Case Western Reserve University	Blk28@case.edu
Billie Jean (B.J.) Kosak	University of Cincinnati	BJkosak@cinci.rr.com
Gary Lawrence	University of Oklahoma	gllawrence@cnhsa.com
Suzette Lettsome	Case Western Reserve University	Suzette_Lettsome@yahoo.com
Sophia Mason	Capella University	smason@lmcmc.com
Marie McDade	University of Michigan	mcdadem@umich.edu
Jan McNeil	MFP Alumna, Class of 2004 Winston Salem State University	Jmcneilrn@aol.com
Eugenia Millender	Florida Atlantic University	eugeniamillender@gmail.com
Beverly Patchell	New Mexico State University	beverlypatchell@gmail.com
Robert Pope	MFP Alumni, Class of 2010 University of California, San Francisco	Robert.Pope@ucsf.edu
Brandon Respress	MFP Alumna, Class of 2010 University of Michigan	brespres@umich.edu
Stephanie Rodriguez	University of California, San Francisco	Loleta.Rodriguez@ucsf.edu
Tanya Sorrell	University of Arizona	tsorrell@gmail.com
Cheryl Woods-Giscombe`	MFP Postdoctoral Alumna, Class of 2009 University of North Carolina, Chapel Hill	Cheryl.Giscombe@unc.edu

SPONSOR

AMERICAN NURSES ASSOCIATION

Overview

The MFP at the ANA grew out of the lack of mental health and substance abuse nurse professionals who could provide culturally competent care to an increasingly diverse population with ever-expanding needs for mental health and substance abuse disorders services, research, advocacy, and policy development in local and international organizations and communities.

Purpose

The purpose of the MFP is to develop ethnic minority nurses who demonstrate excellence in creating, transmitting, and utilizing knowledge to improve the health of all people in local and global communities. The intent is to increase the number of doctoral-prepared nurses from underrepresented ethnic minority groups who will assume leadership roles in providing quality clinical services, conducting research, and advocating for and developing policy related to mental health and substance abuse disorders prevention, treatment, and recovery.

Eligibility Requirements

- U.S Citizenship or Permanent Residency

- Registered professional nurse

- Full-time enrollment in an accredited traditional or accelerated doctoral program

- Membership in the ANA

Selection Criteria

- Evidence of experiences in and commitment to minority mental health and/or substance abuse services, research, advocacy, and policy

- Depth and quality of the proposed training program

- Certification or certification eligible in mental health and/or substance abuse

- Documented potential for successfully completing doctoral studies

- Qualifications of the academic advisor(s) and doctoral committee members

- Congruence with the SAMHSA mission and program goals

- A signed career statement indicating the individual will be employed/volunteer in one of two specialty areas

ACCOMMODATIONS

Washington Duke Inn & Golf Club
3001 Cameron Boulevard
Durham, NC 27705
Telephone: 919.490.0999
Fax: 919.313.2164

The Washington Duke Inn & Golf Club is a smoke-free facility.

The MFP has reserved a room for you. The room charge for February 10-12 will be billed directly to the MFP. You are responsible for any room incidental charges and hotel accommodations on dates other than February 10-12. As is the standard practice at the MFP, each Fellow has been assigned a roommate. Please use this opportunity to converse with your roommate about research ideas and design strategies, review your statistical and research assignments, or discuss lessons learned during the day with your roommate. You will recall that we refer to this time as the “Evening Incubator” for Ideas in Science and Service.

Checking into the Washington Duke Inn & Golf Resort

Check In: 3:00pm, February 10, 2011

Upon check in, each individual must present a credit card or a cash deposit for payment of incidental charges. Early room occupancy on the day of arrival cannot be guaranteed, but the hotel will gladly store baggage until rooms are available.

Check Out: 12 noon, February 13, 2011

Late Check Out

Complimentary late check-outs on the day of departure are confirmed on the day of departure and at the discretion of the Reception Manager. A guest retaining occupancy of a room after 12 noon without the consent of the Reception Manager will be charged a half-day’s rate plus tax at the prevailing rate of the day. A guest retaining occupancy of a room after 6:00pm without the consent of the Reception Manager will be charged a full day’s rate plus tax at the prevailing selling rate of the day.

Attire

During the Institute, comfortable, casual business attire is recommended and comfortable shoes.

Transportation

Local Ground Transportation will be provided by Elite Coach. Fellows will be provided confirmation numbers for their roundtrip airport transportation. If a Fellow cannot locate the representative from Elite Coach, in the airport baggage claim area, please call the toll free number, 1.800.569.9484 or Janet Jackson at 240.543.4611. Failure to contact the toll free number and/or Janet Jackson before arranging your own alternative transportation will result in a No-Show which is equal to the value of the transportation cost. This expense will be charged directly to the Fellow.

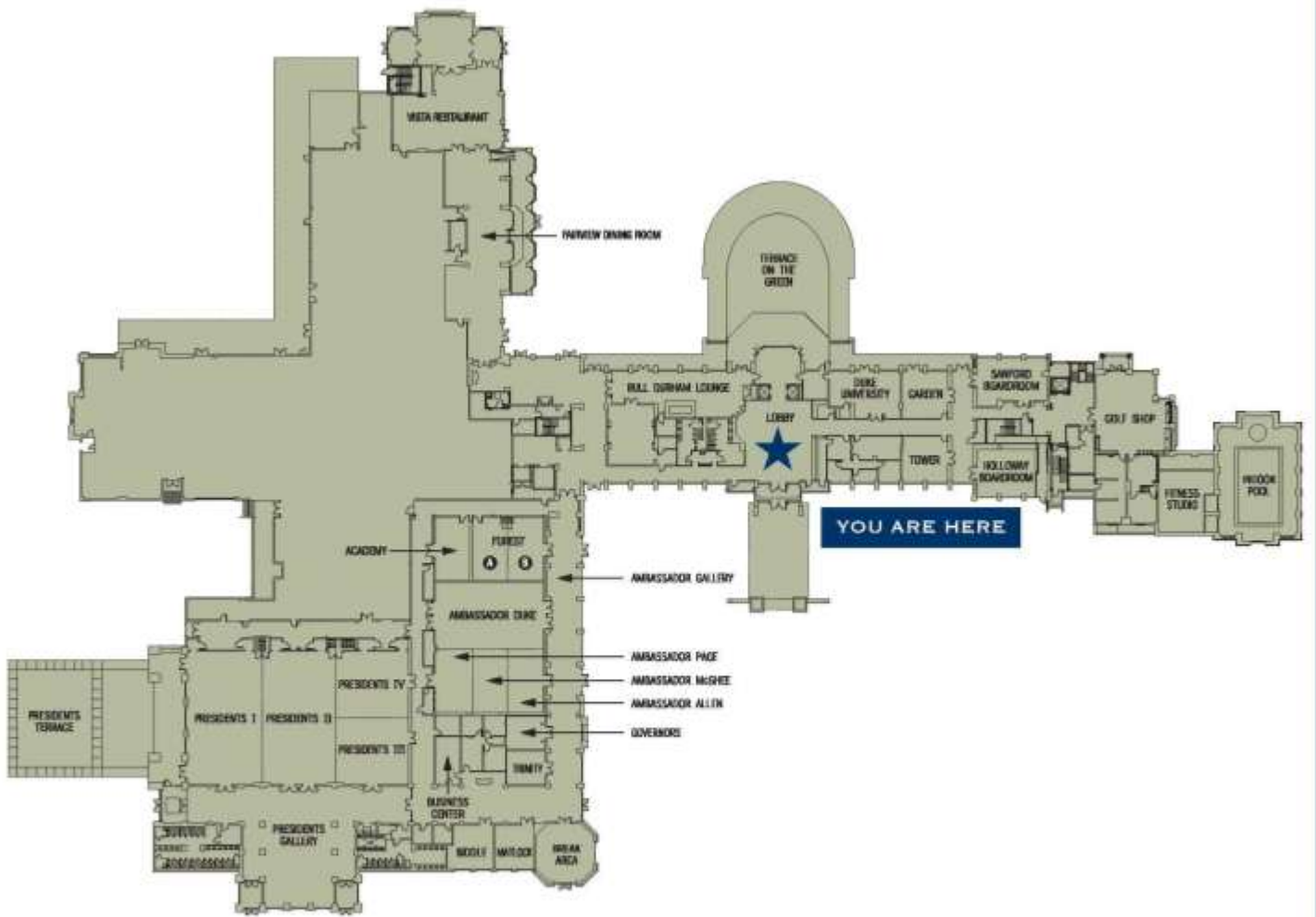

Washington Duke
Inn & Golf Club

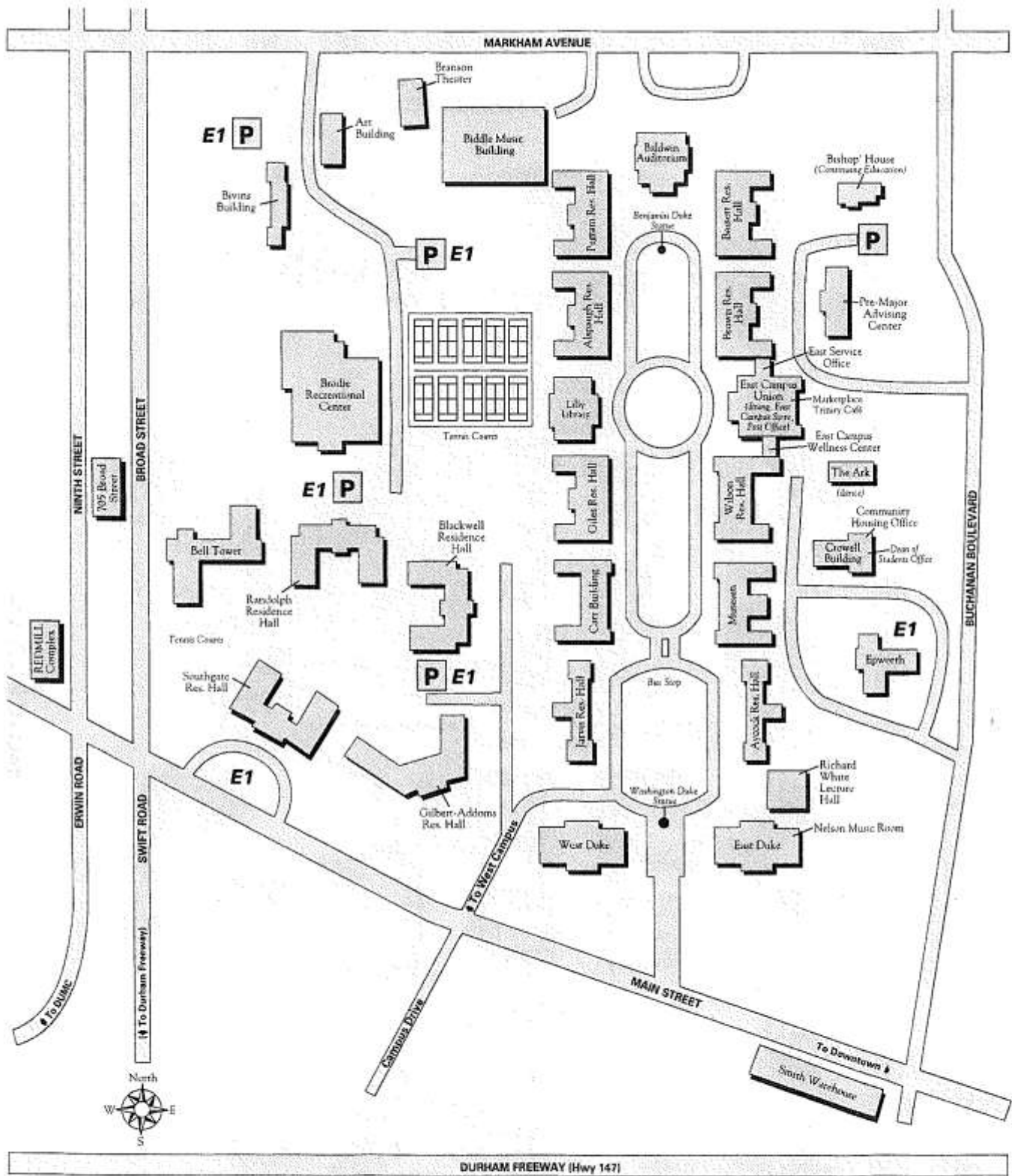

DUKE UNIVERSITY
East Campus

Published by the Department of Event Management • September 2006 Duke University
 Map is not to scale • Rev #9921

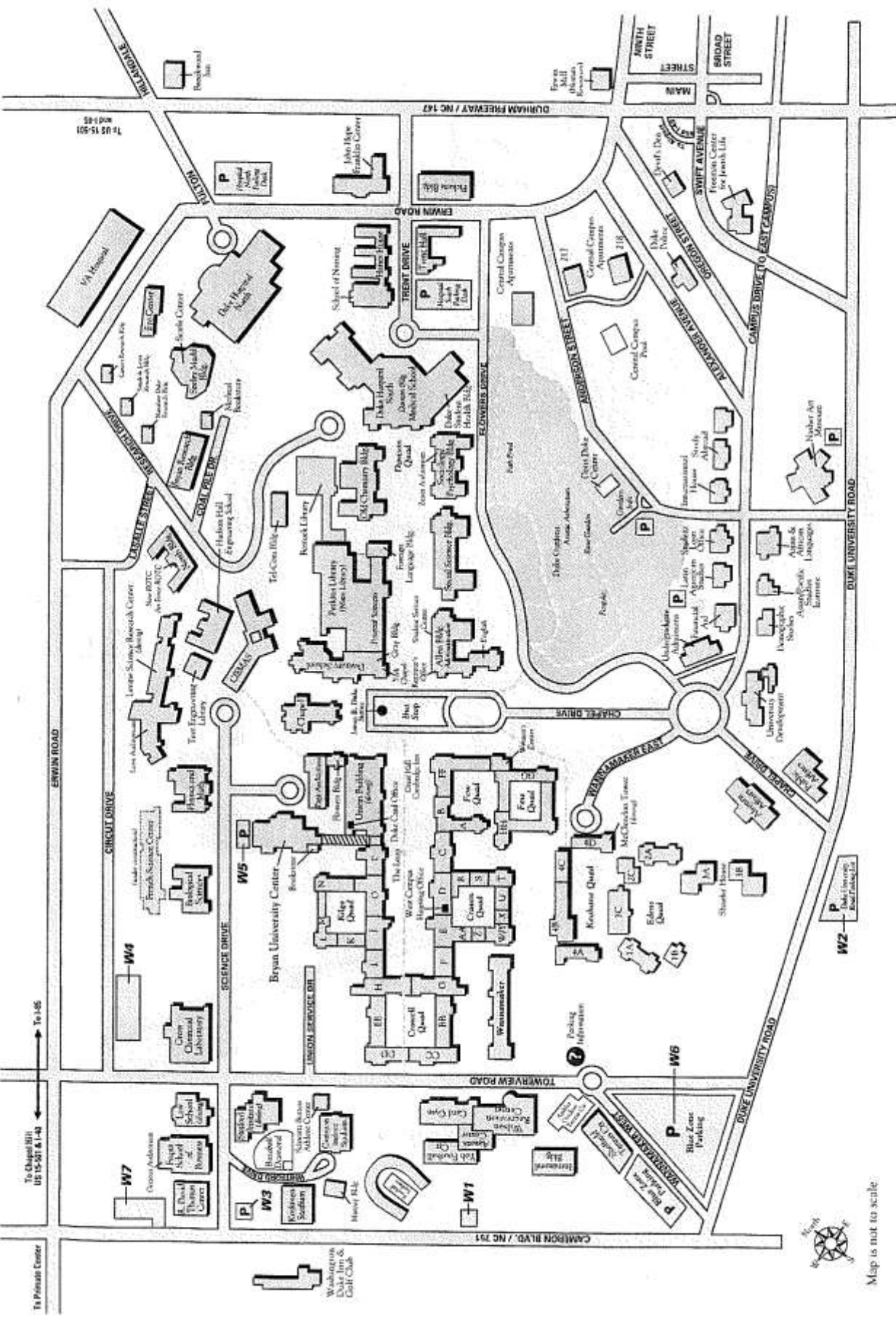

DUKE UNIVERSITY
West Campus

Map is not to scale.

MFP Goal

To facilitate the entry of ethnic minority students into mental health and substance abuse treatment training and increase the pool of minority professionals who can become leaders in the field, train the next generation, and provide services to underserved populations in our increasingly diverse society.

American Nurses Association
SAMHSA Minority Fellowship Program
8515 Georgia Avenue, Suite 400
Silver Spring, MD 20910-3492
Phone: 301-628-5247; Fax: 301-628-5339
Web: www.emfp.org
Facebook: www.facebook.com/samhsamfp
Twitter: www.twitter.com/anamfp